

Carter

carter products

THE PERFECT HOLLOWER

INSTALLATION INSTRUCTIONS



WARNING: Cancer and Reproductive Harm www.P65Warnings.ca.gov

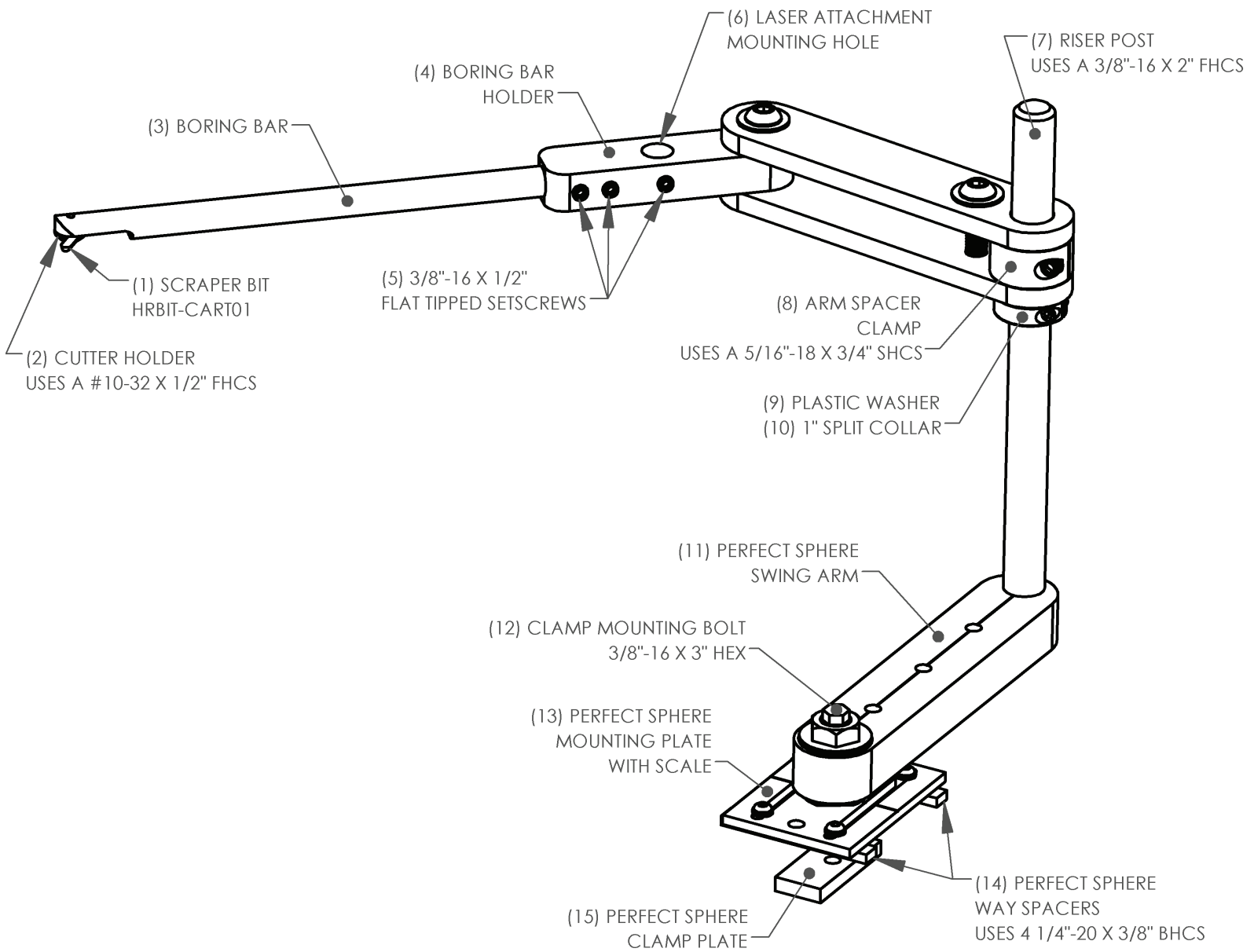

INSTALLATION INSTRUCTIONS

1. Adjust the Way Spacers (14) to center the Mounting Plate With Scale (13) on your lathe(Fig.1). The Mounting Plate With Scale (13) has a scale marked on the outside of each of the slots. Position the Way Spacers (14) so they contact each side of the lathe ways and so the outer edges of the Way Spacers are on the same marks on the scale from the centerline of the mounting plate (13). Once the Way Spacers (14) are in contact with the inside edges of your lathe ways and centered on the Mounting Plate With Scale (13), tighten the Way Spacer Locking Bolts to secure them in place (Fig.2). This will make sure the Perfect Hollower Tool is always centered on your lathe and should only need to be done on the initial set up or when you want to use the tool on a different lathe.

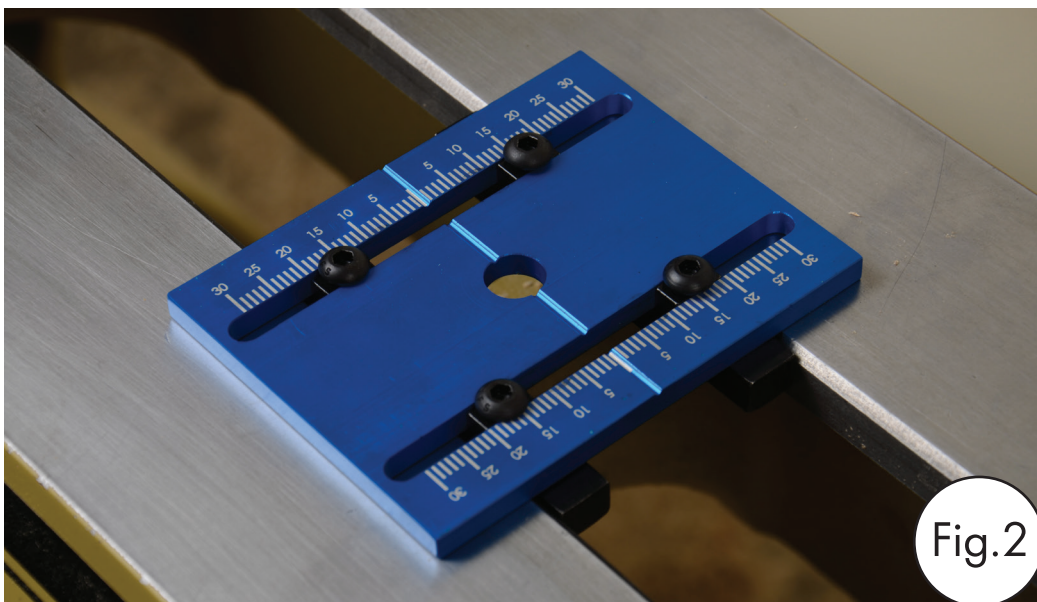
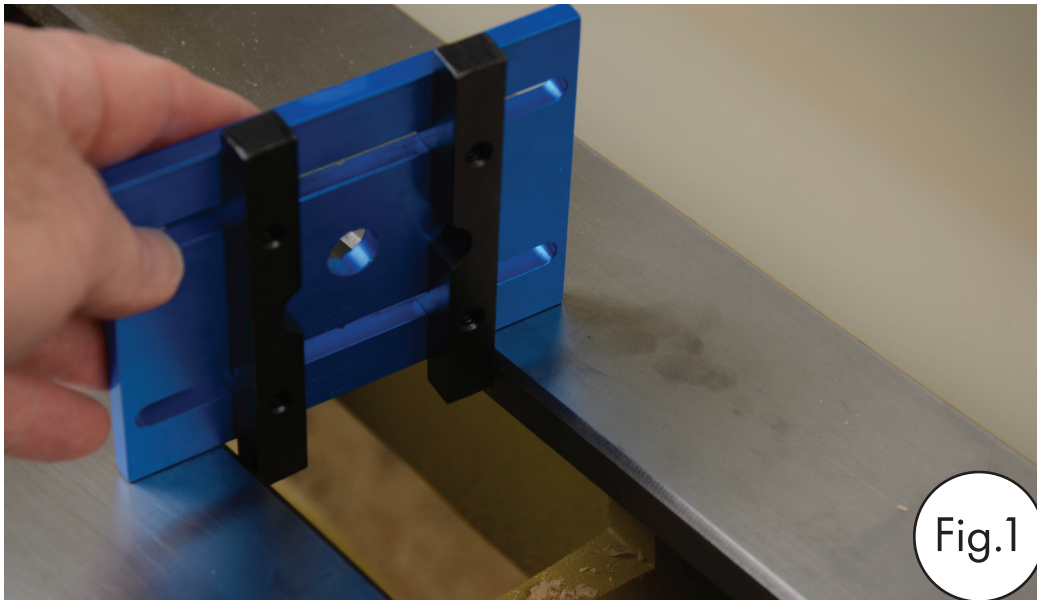

2. Insert the Clamp Mounting Bolt (12) through the Perfect Sphere Swing Arm (11) and the Mounting Plate with Scale (13) and thread the Clamp Plate (15) onto the Clamp Mounting Bolt (12). Rotate the Clamping Block (15) 90 degrees to lathe ways and tighten the Clamping Bolt (12) to secure Sphere Tool to lathe. **NOTE: It may be helpful to support the weight of the tool and Swing Arm (11) while tightening the Sphere Tool to the lathe with a 1/2" thick wood spacer between the Swing Arm (11) and the top of the lathe ways.**

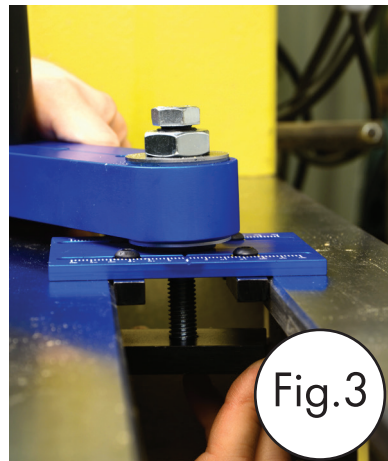

NOTE: The Bearing Assembly in the Perfect Sphere Swing Arm (11) anchor end has been set at the factory to put a small amount of drag on the bearing when rotating the swing arm from side to side. This drag can be adjusted by slightly (1/8 turn at a time) loosening or tightening the large silver nut on the top of the swing arm (Fig.4) while holding the black two flats on the bottom of the swing arm (Fig. 5).



3. Install the Boring Bar (3) in the end of the Boring Bar Holder (4) with the notch in the bar facing down and level with the bed of the lathe (Fig. 6). Secure the Boring Bar (3) by tightening the 2-3/8" set screws.



4. Install the Scraper Bit (1) and the Cutter Holder (2) to the threaded end of the Boring Bar (3) as shown in Fig. 7.



5. Adjust your tool rest up to support the bottom of the Boring Bar (3). We recommend your tool rest be located 1 to 2 inches off the face of your work piece. (Fig. 8)



HOLLOWING TIPS

1. Once the Perfect Hollower is fully assembled and installed to your lathe, you are ready to begin your hollowing project. Before turning with the Perfect Hollower, it is ideal to begin with the system retracted as shown in Fig. 9, which allows for a smoother hollowing while you gradually hollow into your project.
2. The included Scraper Bit (1) works best at a 45-degree angle facing away from the bar, but can be placed at any angle to reach the base of your work piece, to the inside shoulder.
3. Hand placement can determine the amount of leverage you have on the tool. Your front hand should be as close to the front tool rest as is comfortable for more control. If you prefer, the tool rest can be grasped over the bar, but make sure to bring the rest back slightly from where you normally would place it to give your front hand enough clearance. Rest your back hand around the Riser Post (7) and the upper swing arm to help guide the Perfect Hollower in and out of the project.
4. For a better finish, you can slightly round the included scraper bit on your grinder. This will result in a smoother finish, but less aggressive cutting. A sharpening/ grinding jig is available as an accessory from Carter or your local Carter dealer.
5. It is important to keep the Boring Bar (3) at center with your work piece and level with the lathe. Make sure your tool rest is at the same height as the center of the work piece to help keep the Perfect Hollower steady.
6. When starting a hollow form, it is easiest to predrill a starting hole in the work piece prior to using the Perfect Hollower. Carter Products has a Strongbore Modular Boring System that attaches to your tail stock and can be adjusted to various lengths to accommodate the size of your work piece.



The Strongbore™ Modular Boring System

Multi-component system allows users to bore starting holes for deeper hollowing or turning. Rigid design excels compared to standard smaller diameter extensions and is compatible with most lathes. 3" & 6" extenders are available to bore larger projects.



The Perfect Hollower™ Laser Guide

Provides a visible wall thickness and depth indicator that allows the user to see when the wall thickness is at the desired measurement or the cutter head is at the desired depth. The thickness is set by the turner prior to inserting the cutting tool into the piece.



Lathe MultiRest™ Work Support System

Compatible with lathe swing sizes from mini up to 20" with no additional hardware required. The unique 2-piece design allows the MultiRest™ to be quickly opened while leaving the mounting base still attached to the lathe bed. This provides easy access when mounting or demounting parts, sanding or shaping.

Still experiencing issues? Call toll free 888.622.7837 or visit www.carterproducts.com

Follow us for news, tips & product updates!



Carter Products Company, Inc.
2871 Northridge Drive NW
Grand Rapids, MI 49544

